

WHEN DISASSEMBLING ALUMINUM EXTRUSION, TIGHTEN ALL SETSCREWS AND LOCKS TO PREVENT LOSS DURING SHIPPING

visionary™ IDESIGNS

Using Your Setup Instructions

The Visionary Designs Setup Instructions are created specifically for your configuration. They are laid out sequentially, including an exploded view of the entire display, and then a logical series of detailed steps to assemble the main structure and components. We encourage you to study the instructions **before** attempting to assemble your exhibit.

Each page reminds you to tighten the setscrews after disassembling your exhibit to prevent loss of the locks and setscrews (see below in RED). This is **VERY IMPORTANT**.

Cleaning and Packing Your Display

- 1) Use care when cleaning aluminum extrusion or acrylic inserts. Use only non-abrasive cleaners.
- 2) When cleaning laminate inserts or countertops, use mild cleansers and a soft material such as cotton.
- 3) Keep all display components away from extreme heat and long exposure to sunlight to avoid warping and fading.
- 4) Retain all packing material. It will make re-packing much easier and will reduce the likelihood of shipping damage.



The Tool

Most Visionary Designs exhibits can be assembled with the supplied Hex Key Tool. Occasionally, a flat head screwdriver may be required.



Detail A

Typical Connection



Typical Connection (cont'd)

Most horizontal extrusion connections have a patented expandable lock. This lock inserts into the groove of an opposing extrusion. Tightening the lock with the Hex Key Tool expands the lock and creates a strong positive connection.

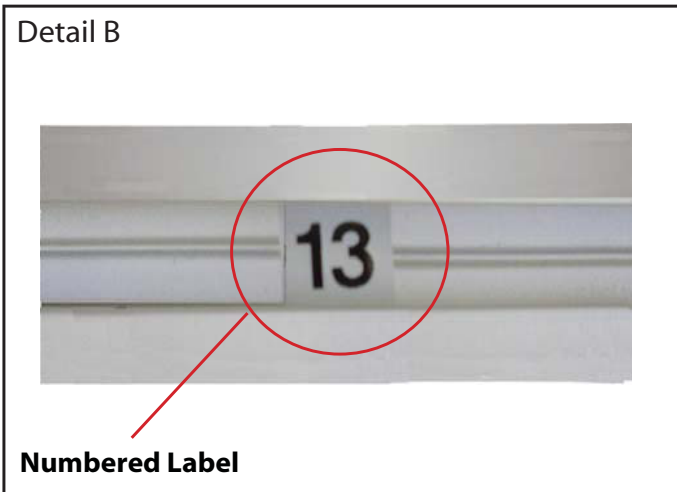

Detail B

Numbered Label

Each extrusion contains a numbered label which corresponds with setup instructions. The label is located within a groove of the extrusion (when possible). With Visionary Designs the labels contain Black numbers unless otherwise specified.



Detail C

Horizontal Inline Connection (remove only one setscrew)

Remove only (1) setscrew when disassembling. Replace setscrew in extrusion after assembling it. Before packing, replace setscrew in extrusion to avoid losing it.

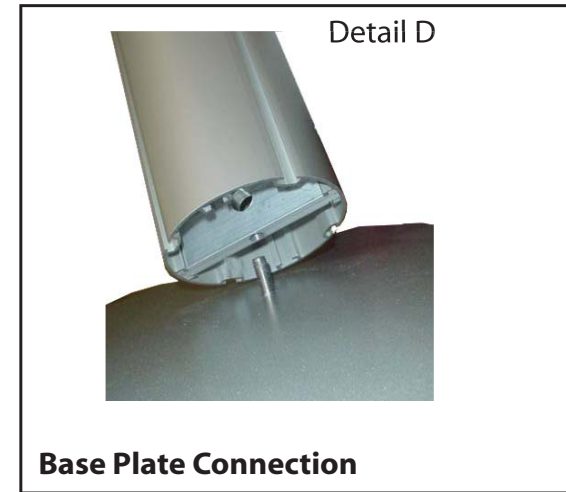

Detail D

Base Plate Connection

Attach base plate to round or square vertical extrusion using the bolt provided. Be careful not to strip the threads.

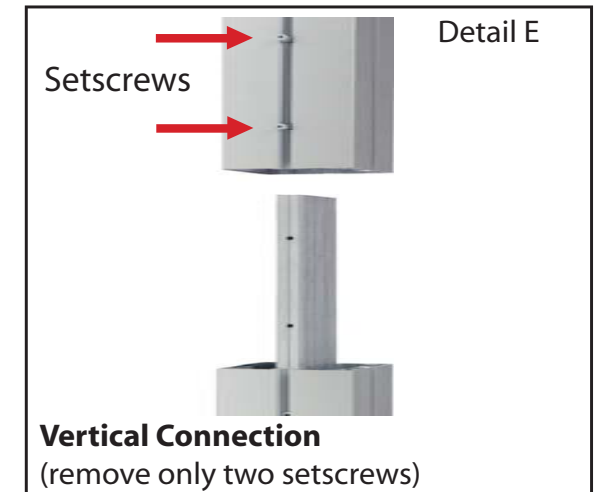

Detail E

Vertical Connection
(remove only two setscrews)

When vertical extrusions are packed in portable cases rather than crates or tubs, they must be broken down into smaller sections which then require assembly.

Remove only (2) setscrews when disassembling. Replace setscrews in extrusion after assembling it. Before packing, replace setscrews in extrusion to avoid losing them.

WHEN DISASSEMBLING ALUMINUM EXTRUSION, TIGHTEN ALL SETSCREWS AND LOCKS TO PREVENT LOSS DURING SHIPPING

866.652.2100

Item	Quantity	Description
1	2	Base Plates
2	2	47.5" Vertical Extrusion
3	2	47.5" Vertical Extrusion
4	1	Horizontal Formed Extrusion
5	1	Horizontal Formed Extrusion w/attached connector
6	1	Horizontal Formed Extrusion
7	1	Horizontal Formed Extrusion w/attached connector
8	2	47.5" Vertical Extrusion
9	2	47.5" Vertical Extrusion
10	2	Horizontal Formed Extrusion
11	1	Upper Horizontal Formed Extrusion
12	1	Upper Horizontal Formed Extrusion
13	1	Upper Horizontal Formed Extrusion

Slide Upper Decorative rings onto vertical extrusion & secure into place.

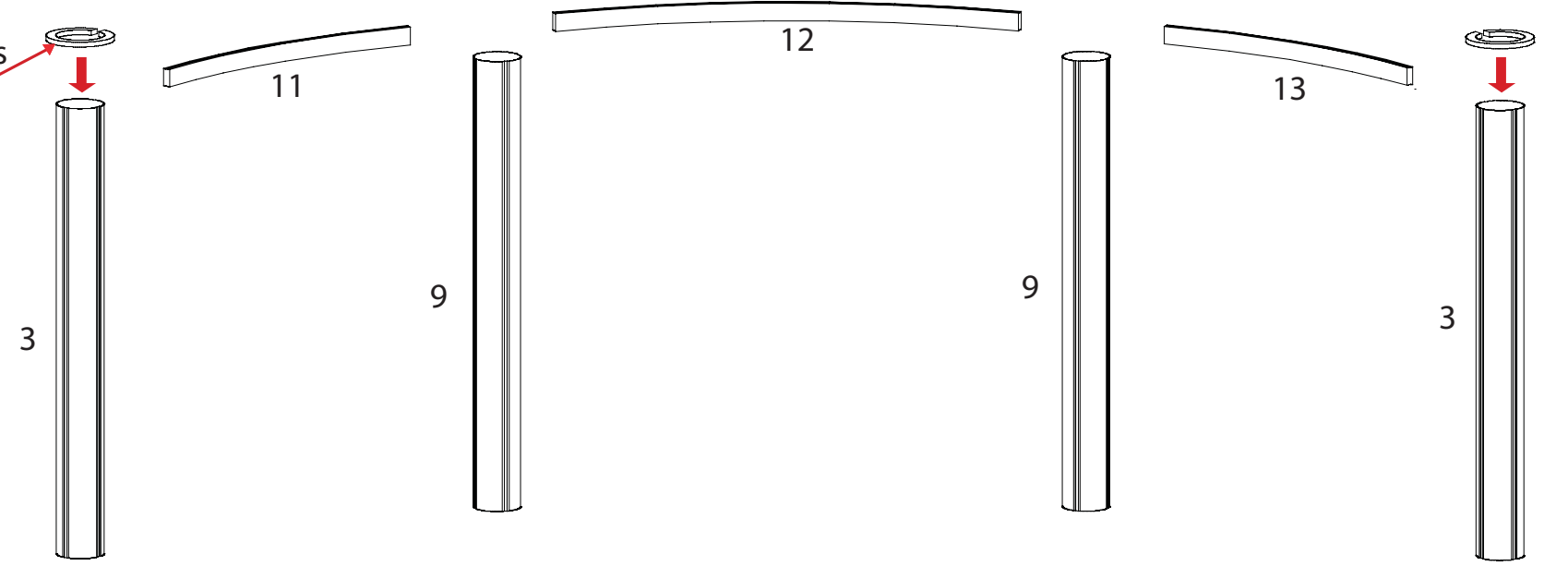

- Steps:
- 1) Attach Vertical extrusions (2 & 3) together to form 92" vertical extrusions. Attach 92" vertical extrusions to base plates (1).
 - 2) Attach Horizontal extrusion (4) to Horizontal extrusion (5) as shown in assembly.
 - 3) Attach Horizontal extrusion (6) to Vertical extrusion (7) as shown in assembly.
 - 4) Attach assembled extrusion (4/5) to (6/7).
 - 5) Attach 92" vertical extrusions (1, 2, & 3) to assembled horizontals (4, 5, 6, & 7).
 - 6) Attach Vertical extrusions (8 & 9) together to form 92" vertical extrusions. Attach to horizontal extrusions (5 & 7) as shown in assembly.
 - 7) Attach horizontal extrusions (10) to vertical extrusions (8/9).
 - 8) Attach horizontal extrusions (11, 12, & 13) to verticals as shown.

Slide Lower Decorative rings onto vertical extrusion before attaching base plates & secure into place.

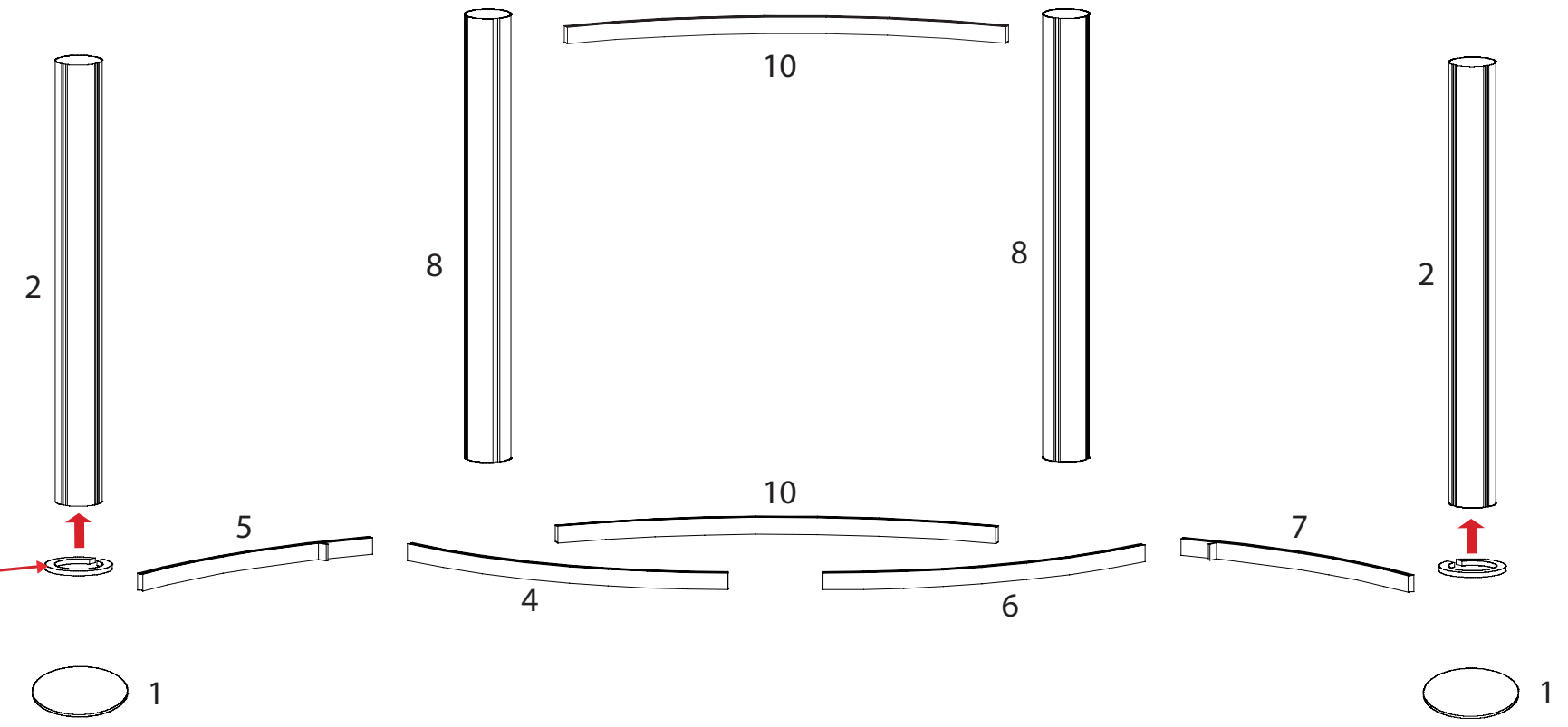

WHEN DISASSEMBLING ALUMINUM EXTRUSION, TIGHTEN ALL SETSCREWS AND LOCKS TO PREVENT LOSS DURING SHIPPING

866.652.2100

Item	Quantity	Description
14	1	33.91"h Vertical Extrusion
15	1	33.91"h Vertical Extrusion
16	1	33.91"h Vertical Extrusion
17	1	33.91"h Vertical Extrusion
18	1	Horizontal Formed Extrusion
19	1	Horizontal Formed Extrusion

Steps:

- 1) Connect Vertical extrusion (14) to horizontal extrusion (4).
Connect Vertical extrusion (15) to horizontal extrusion (4).
Connect Vertical extrusion (16) to horizontal extrusion (6).
Connect Vertical extrusion (17) to horizontal extrusion (6).
- 2) Insert sentra panels (A,B, & C) into vertical extrusions as shown.
- 3) Connect Horizontal extrusion (18) to vertical extrusion (14 & 15).
Connect Horizontal extrusion (19) to vertical extrusion (16 & 17).
- 4) Set shelf in place, then place counter atop back extrusion (10) & front extrusions (18 & 19).

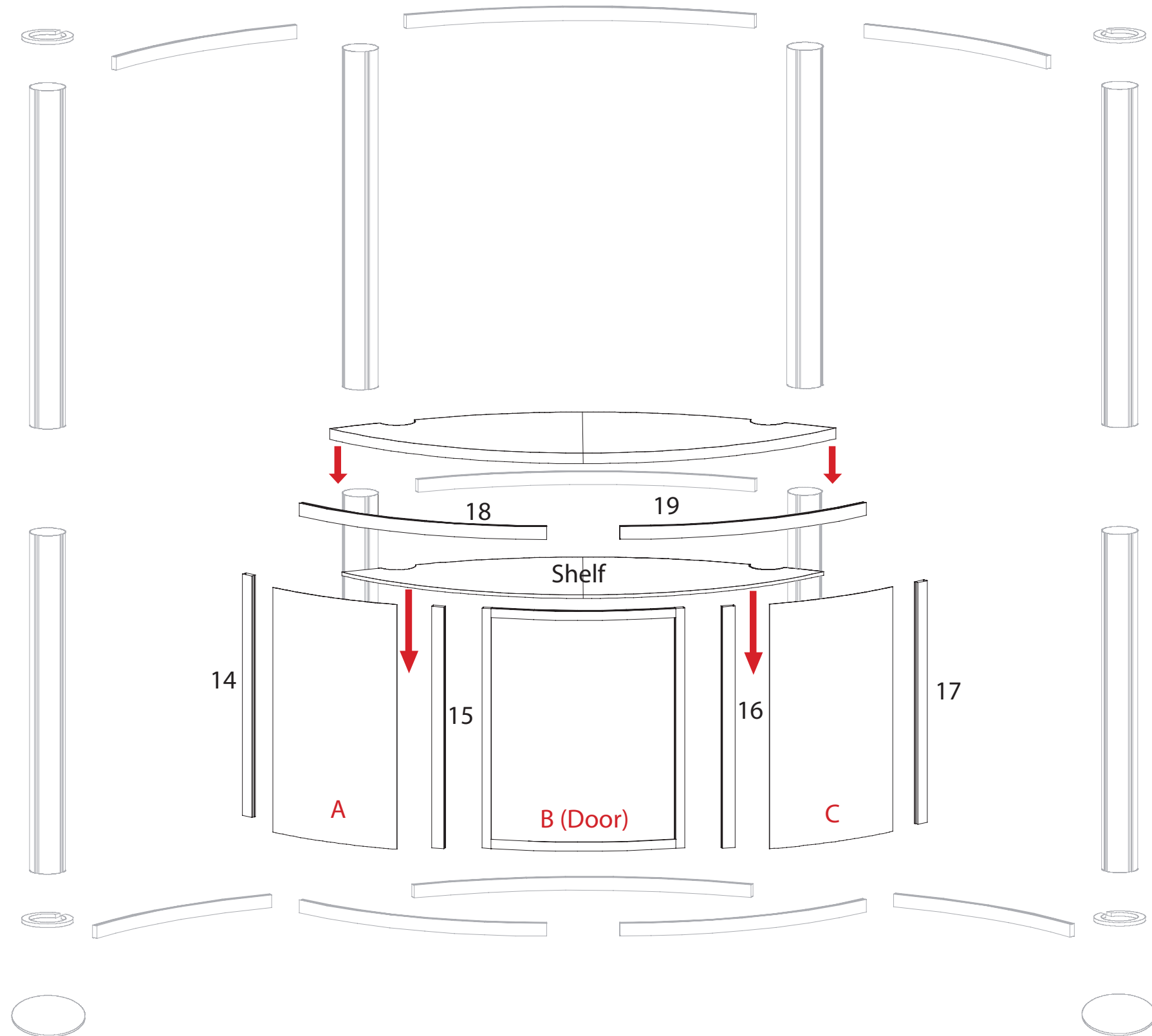

WHEN DISASSEMBLING ALUMINUM EXTRUSION, TIGHTEN ALL SETSCREWS AND LOCKS TO PREVENT LOSS DURING SHIPPING

866.652.2100

Item	Quantity	Description
20	1	36.8" h Tapered Extrusion Support
21	1	36.8" h Tapered Extrusion Support

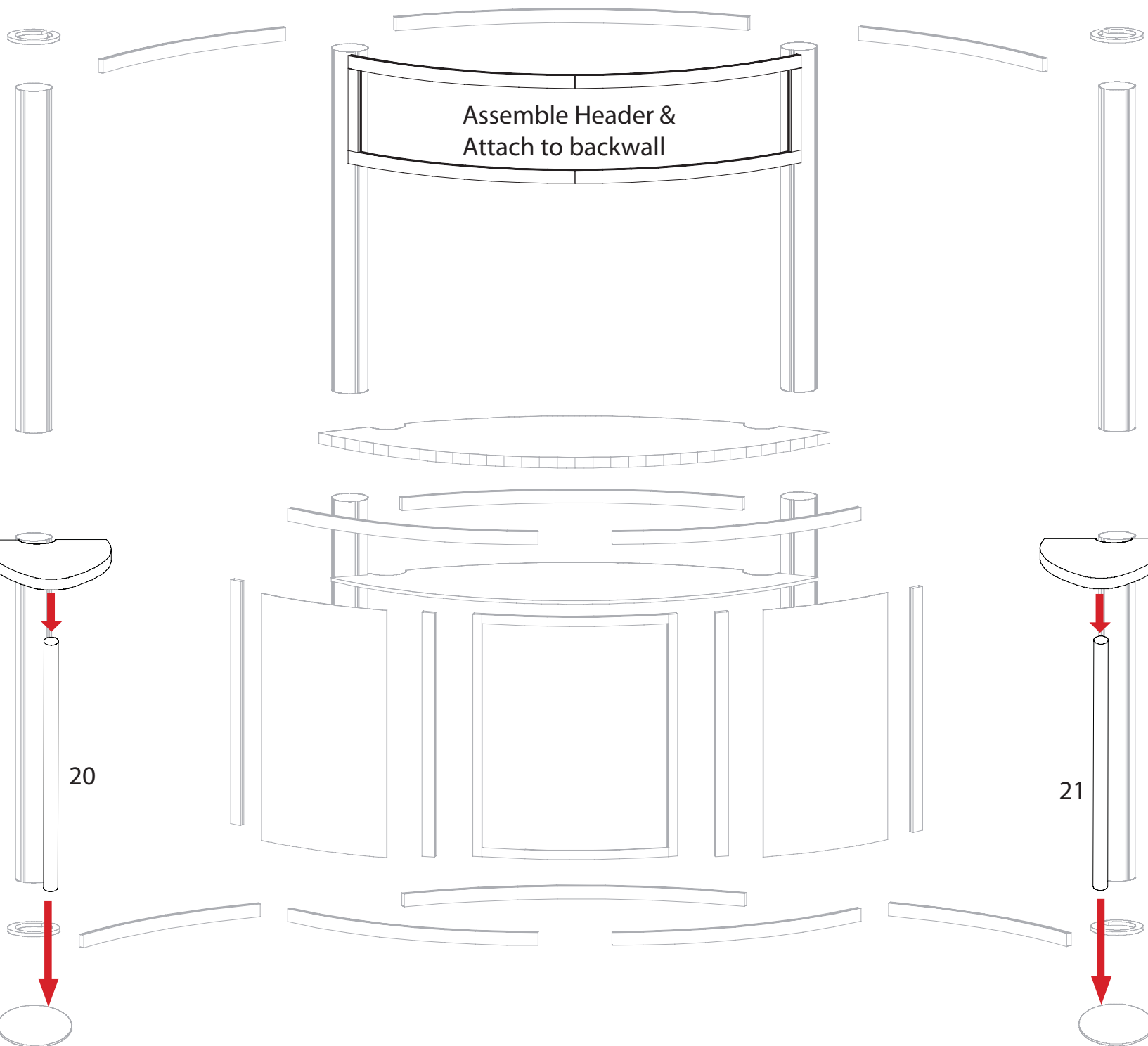

Steps:

- 1) Connect 36.8" h Tapered extrusion supports (20 & 21) to base plates (1).
- 2) Set workstation counters atop extrusion as shown.
- 3) Attach header assembly to backwall as shown.

WHEN DISASSEMBLING ALUMINUM EXTRUSION, TIGHTEN ALL SETSCREWS AND LOCKS TO PREVENT LOSS DURING SHIPPING

Item	Quantity	Description
22	1	Horizontal Formed Extrusion
23	1	37" Vertical Extrusion
24	1	Horizontal Formed Extrusion
25	1	37" Vertical Extrusion
26	1	Horizontal Formed Extrusion
27	1	37" Vertical Extrusion
28	1	Horizontal Formed Extrusion
29	1	37" Vertical Extrusion
30	1	Horizontal Formed Extrusion
31	1	Horizontal Formed Extrusion
32	1	Horizontal Formed Extrusion
33	1	Horizontal Formed Extrusion

Steps:

- 1) Connect horizontal extrusion (22) to 38" vertical extrusion (23).
Continue in numerical order.
- 2) Insert Sentra panels (D,E,F, & G) into vertical extrusions as shown.
- 3) Connect horizontal extrusion (30) to 38" vertical extrusions (23 & 29).
Continue in numerical order.
- 4) Place shelf into pedestal assembly atop supports.

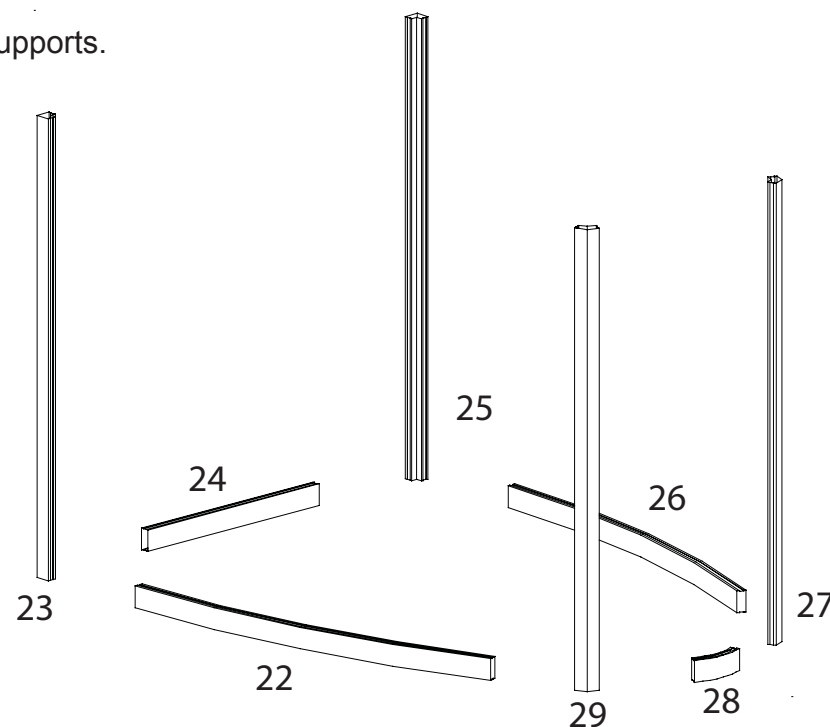

Set counter atop assembled pedestal.

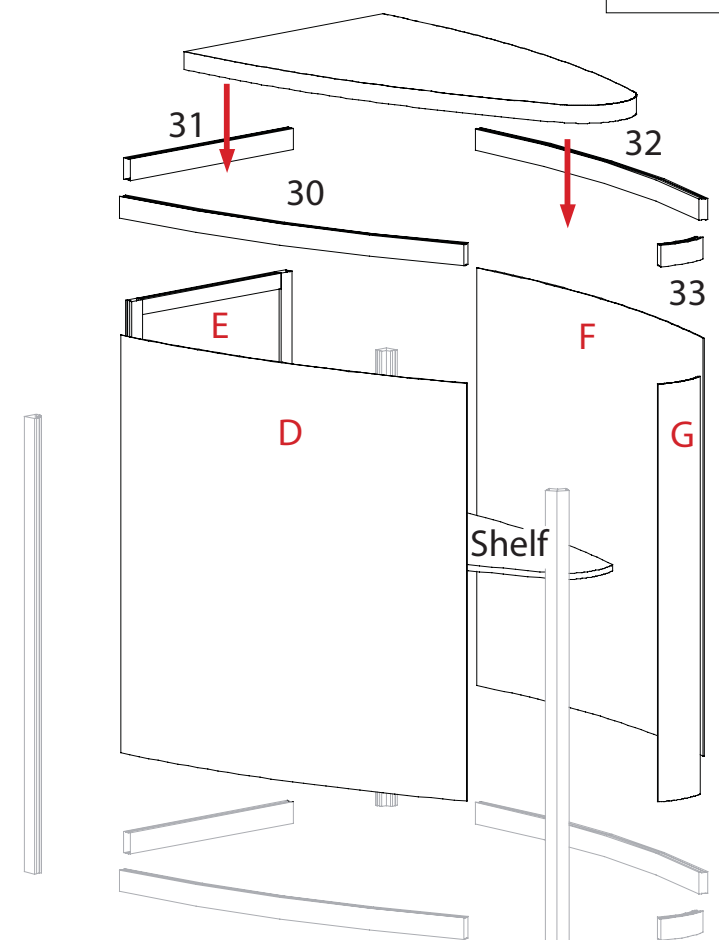
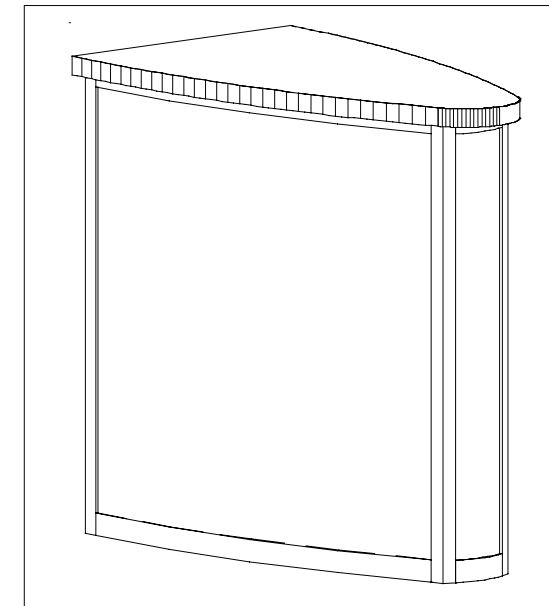

WHEN DISASSEMBLING ALUMINUM EXTRUSION, TIGHTEN ALL SETSCREWS AND LOCKS TO PREVENT LOSS DURING SHIPPING